

Holmbury Court Colliers Wood, SW19 2EU

£379,000 Leasehold



Two double bedroom purpose built apartment moments from Colliers Wood high street and tube station. No onward chain, spacious lounge/diner and private garage. The flat is also being sold with the benefit of a long lease. This is a fantastic flat for a first time buyer or investor looking to get onto the property market.

Holmbury Court, SW19

Approximate Gross Internal Area
47.4 sq m / 510 sq ft

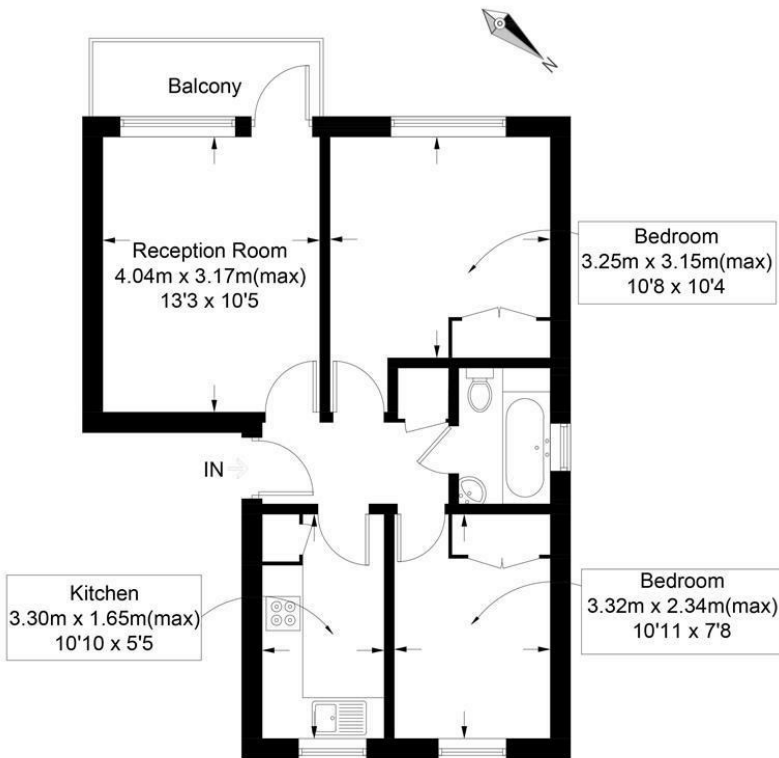

This floor plan is for representation purposes only and is not drawn to scale. Whilst every attempt has been made to ensure its accuracy measurements are approximate only and should be checked before making any decisions reliant upon them.
Copyright Bespokeplans.co.uk 2017
(ID 317622)

- Two Bedrooms
- Quiet cul-de-sac Location
- Private Balcony
- Garage
- Long lease
- EPC Rating C

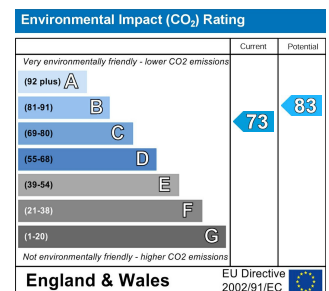
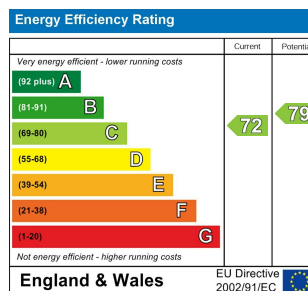

For Free Mortgage Quote and Best Mortgage Rates, call an Ellisons Mortgage Advisor on 020 8544 0518



Although these particulars are believed to be correct, their accuracy is not guaranteed and they do not form part of any contract.

Celebrating 30 years of successful Sales and Lettings in Merton

